

GUANGZHOU HAOQING MOTOR CO.,LTD



YE2

系列高效三相异步电动机

SERIES HIGH EFFICIENCY THREE-PHASE INDUCTION MOTOR

E-mail: sherry@gzhqmotor.com

Website: <http://www.gzhqmotor.com>

YE2

系列高效三相异步电动机
SERIES HIGH EFFICIENCY THREE-PHASE INDUCTION MOTOR

产品概述

YE2系列三相异步电动机符合GB 18613-2012《中小型三相异步电动机能效限定值及能效等级》中规定的三级效率标准。同时，符合IEC60034-30-2008标准的IE2能效等级。

其提高效率设计，符合国家对生产制造行业提出节能降耗的要求。

YE2系列电机的安装尺寸符合IEC60034标准。具有结构合理，外形美观，效率高，噪音低，防护等级、绝缘等级高等优点，可广泛应用于风机、水泵、机床、压缩机运输机械等驱动各种通用机械设备，也可在石油、化工、钢铁、矿山等其它环境比较恶劣的场所使用。

详细说明

◆现场条件

YE2系列电动机可适用于大多数的场合及环境。电动机标准工作条件为-20℃到+40℃，海拔1000米。

◆温升和绝缘

电动机按F级绝缘设计（155℃），按B级绝缘考核（80K），电动机的使用寿命和可靠性得到保证。

◆冷却和通风

标准冷却方式为全封闭自扇冷（TEFC）。标准电机装有辅流式塑料风扇。符合IEC 60034-6中IC411的规定。

◆防护等级

电动机的防护等级为IP55，可用于含尘或潮湿环境。也可根据客户要求提供更高防护等级的电动机。

◆电机保护

可根据要求安装PTC、PT100等绕组和轴承测温及保护装置。

◆电压、频率

标准电机为380V/50HZ。可设计200-660V范围内任意电压的50Hz的电动机。在供电电压偏离额定电压±5%的情况下，仍能良好运行。

◆振动

YE2系列电动机在空载时振动速度等级符合A级。特殊要求时，可提供B级电动机。

◆接线盒位置

接线盒在机座上方或右侧为标准YE2系列电机。

◆质量保证

从产品设计到产品出厂，遵循ISO9001质量认证体系，严格遵守质量程序。

PRODUCT INTRODUCTION

The three-phase asynchronous motor of the YE2 series is in line with the third efficiency standard in the provisions of GB 18613-2012 "the energy efficiency limit and the energy efficiency rating of small and medium-sized three-phase asynchronous motors". And the improvement of the efficiency in its design is in line with the state's requirements on the energy saving and consumption reducing of the manufacturing sector.

YE2 series motors with the mounting dimension in accordance with standard IEC60034, It has good features like optimum structure, attractive appearance, low noise, high efficiency, high protection class as well as high insulation class. YE2 series motors can be widely used in various kinds of general use machineries like fans, pumps, machine tools, compressors, transportation and so on, and can also be used in the hazardous areas with oil and chemical, steel plants, mining industry.

SPECIFICATION

Site conditions

YE2 series motors are suitable for almost all applications and operate satisfactorily at temperatures from -20℃ to +40℃ and altitudes up to 1000 meters above sea level.

Temperature and insulation

The Motors' insulation system are designed by Class F(155℃), operated with Class B(80K). Which increase the motor useful life and reliability.

Cooling and ventilation

The standard cooling method is totally Enclosed Fan Cooled(TEFC) in accordance with IC411 of IEC60034-6. Standard motors are equipped with radialflow plastic fans.

Protection class

The standard degrees of protection is IP55. The IP55 enclosure means complete hoseproof and dustproof protection. A higher degrees of protection is available.

Motor protection

Motors can be installed with PTC, PT100, such as winding and bearing temperature measurement as well as other kinds of protection on request.

Voltage and frequency

Standard voltage and frequency are 380V 50HZ, and can be wound for any single voltage in the range 200-660V at a frequency 50. The motors will operate satisfactorily with variations of ±5% from the rated voltage.

Vibration

YE2 motors are designed to vibration class A, vibration class B is available on request.

Terminal box location

Terminal box at the top or right of frame is the standard YE2 motor.

Quality assurance

Stringent quality procedures are observed from first design to finished products in accordance with ISO9001 documented quality systems.

防护等级 Degrees of protection(IEC 60034 -5)

符号 Designation	第一位数字 First numeral	第二位数字 Second numeral
	防止固体异物进入内部及防止人体触及内部的带电或运动部分。 Protection against contact and ingress of foreign bodies. protection against hazardous "live" parts and moving mechanical parts.	防护水 Protection against water
	5.虽不能完全防止灰尘进入,但进尘量不足以影响电机正常运行。能防止触及或接近壳内带电或转动部分。 Ingress of dust is not totally prevented, but dust shall not interfere with the satisfactory operation of equipment. A probe of 1mm diameter shall not penetrate the enclosure.	5.任何方向的喷水对电机应无有害的影响。 What projected in jets against the enclosure from any direction will have no harmful effects.
	6.完全防止灰尘进入机壳。 No ingress of dust.	6.强力喷水时电机应无有害影响。 What projected in power jets shall have no harmful effects.
IP55	防尘 Dust protected	防喷水 Jetting water
IP56	防尘 Dust protected	防强力喷水 Powerful Jetting
IP65	尘密 Dust tight	防喷水 Jetting water
IP66	尘密 Dust tight	防强力喷水 Powerful Jetting

安装形式 Mounting arrangements

卧式底脚安装 Foot mig horiz	凸缘安装 Flange mig	底脚凸缘安装 Foot/Flange mig	立式底脚安装 Foot mig vert
B3 IM1001 H80 ~ 355	B5 IM3001 H80 ~ 280	B35 IM2001 H80 ~ 355	
B6 IM1051 H80 ~ 160	V1 IM3011 H80 ~ 355	V15 IM2011 H80 ~ 160	V5 IM1011 H80 ~ 160
B7 IM1061 H80 ~ 160	V3 IM3031 H80 ~ 160	V36 IM2031 H80 ~ 160	V6 IM1031 H80 ~ 160
B8 IM1071 H80 ~ 160			

接线指示图

鼠笼式三相电动机

Connection diagrams

Three phase motors with cage rotor

单绕组双速电动机 Connection diagrams Three phase motors with cage rotor			双绕组双速电动机 Multi-speed motors with 2 separate windings			
Y接 Star connection	△接 delta connection	Y-△启动连接 connection to	低速 low speed	高速 high speed	低速 low speed	高速 high speed

装配图及零部件明细表 Arrangement and parts list

YE2-80~132 FRAME

零部件名称	Parts Description
1、驱动端端盖	1、Endshield D.E
2、波形弹簧	2、Wave washer
3、驱动端轴承	3、Bearing D.E.
4、接线盒	4、Terminal box
5、定子铁芯	5、Stator lamination pack
6、转子铁芯	6、Rotor lamination pack
7、机座	7、Frame
8、非驱动端轴承	8、Bearing N.D.E.
9、非驱动端端盖	9、Endshield N.D.E.
10、风扇	10、Fan
11、风罩	11、Fan cowl

基本结构说明 Specifications standard construction	
铸铁机座和接线盒	Cast iron frame,terminal box.
钢板冲压风罩	Pressed steel fan cowl.
铸铁端盖	Cast iron endshields.
聚丙烯玻璃纤维风扇	Polypropylene,glass reinforced fan.
电机专用轴承	Equivalent bearings.
特性 Features	
电机尺寸和额定功率符合IEC 60072	Dimensions and ratings to IEC 60072
GB/T4772.1~4772.3	GB/T4772.1-4772.3
IP55	IP55
接线盒在上面	Top mounted terminal box.
接线盒可90° 旋转	Terminal box rotates in 90 deg
冷却方式IC411	Cooling IC411
安装 Mounting	
B3-卧式底脚安装	B3-foot mounted
B5-卧式凸缘安装	B5-flange mounted-horizontal.
B35-底脚凸缘安装	B35-foot and flange mounted
V1-立式凸缘安装	V1-flange mounted-vertical

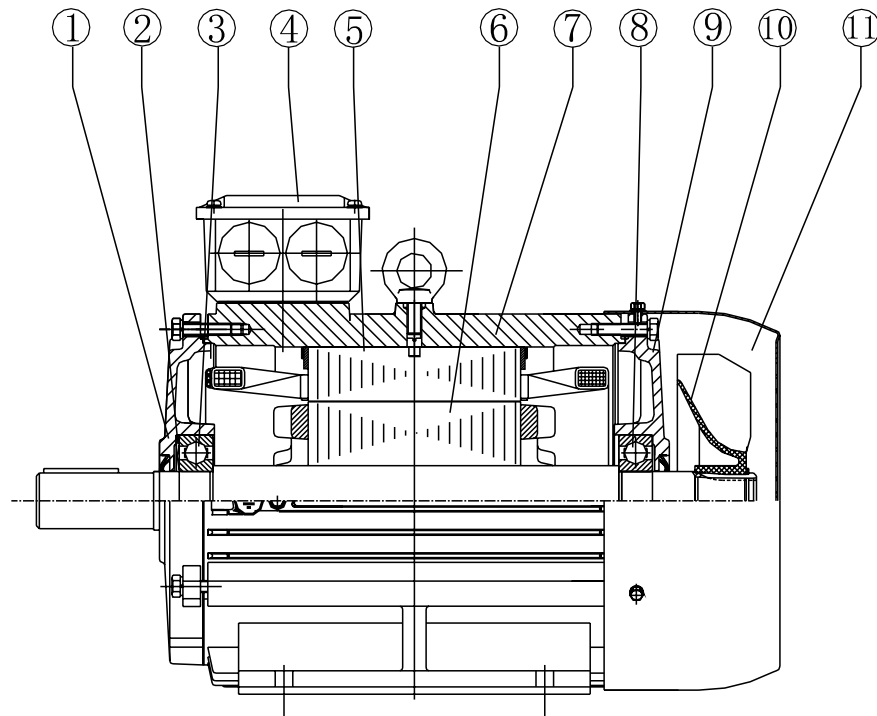

装配图及零部件明细表 Arrangement and parts list

YE2-160~280 FRAME

零部件名称	Parts Description
1、驱动端端盖	1、Outer bearing cap D.E
2、波形弹簧	2、Wave washer
3、驱动端端盖	3、Endshield D.E.
4、驱动端轴承	4、Bearing D.E.
5、驱动端轴承内盖	5、Inner bearing cap D.E.
6、接线盒	6、Terminal box.
7、定子铁芯	7、Stator lamination pack.
8、转子铁芯	8、Rotor lamination pack.
9、机座	9、Frame
10、非驱动端轴承内盖	10、Inner bearing cap N.D.E.
11、非驱动端轴承	11、Bearing N.D.E.
12、非驱动端端盖	12、Endshield N.D.E.
13、非驱动端端盖外盖	13、Out bearing cap N.D.E.
14、风扇	14、Fan
15、风罩	15、Fan cowl

基本结构说明 Specifications standard construction	
铸铁机座和接线盒	Cast iron frame,terminal box.
钢板冲压风罩	Pressed steel fan cowl.
铸铁端盖	Cast iron endshields.
聚丙烯玻璃纤维风扇	Polypropylene,glass reinforced fan.
电机专用轴承	Equivalent bearings.
特性 Features	
电机尺寸和额定功率符合IEC 60072	Dimensions and ratings to IEC 60072
GB/T4772.1~4772.3	GB/T4772.1-4772.3
IP55	IP55
接线盒在上面	Top mounted terminal box.
接线盒可90° 旋转	Terminal box rotates in 90 deg
冷却方式IC411	Cooling IC411
安装 Mounting	
B3-卧式底脚安装	B3-foot mounted
B5-卧式凸缘安装	B5-flange mounted-horizontal.
B35-底脚凸缘安装	B35-foot and flange mounted
V1-立式凸缘安装	V1-flange mounted-vertical

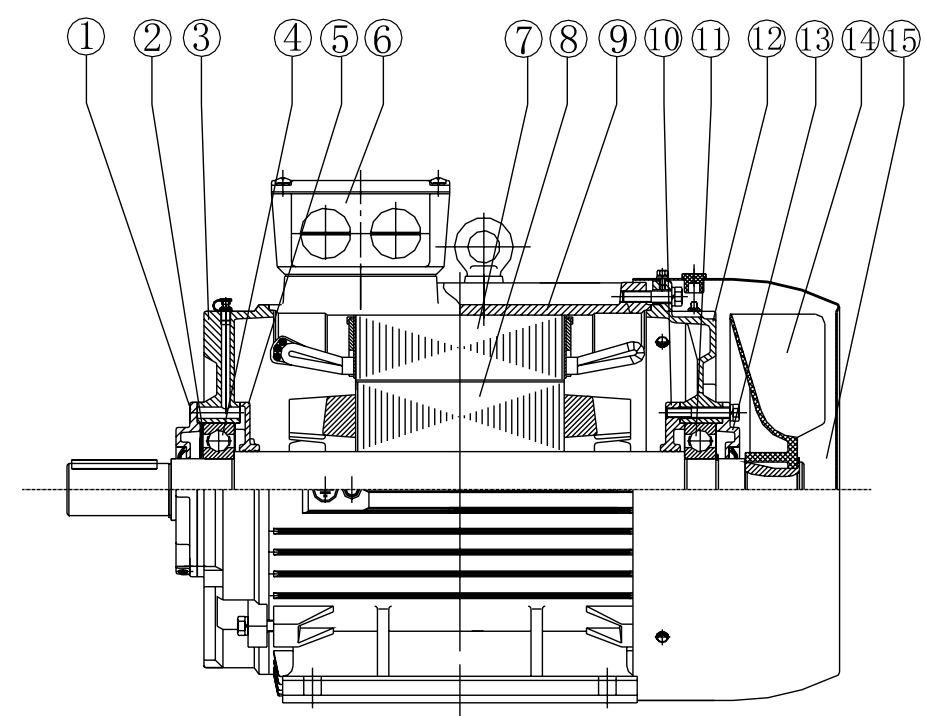

YE2 系列高效三相异步电动机
SERIES HIGH EFFICIENCY THREE-PHASE INDUCTION MOTOR

装配图及零部件明细表 Arrangement and parts list

YE2-315~355 FRAME

零部件名称	Parts Description
1、驱动端轴承外盖	1、Outer bearing cap D.E.
2、驱动端甩油盘	2、Flinger D.E.
3、驱动端端盖	3、Endshield D.E.
4、驱动端轴承	4、Bearing D.E.
5、驱动端轴承内盖	5、Inner bearing cap D.E.
6、接线盒	6、Terminal box.
7、定子铁芯	7、Stator lamination pack.
8、转子铁芯	8、Rotor lamination pack.
9、机座	9、Frame
10、非驱动端轴承内盖	10、Inner bearing cap N.D.E.
11、非驱动端端盖	11、Endshield N.D.E.
12、非驱动端轴承	12、Bearing N.D.E.
13、非驱动端甩油盘	13、Flinger N.D.E.
14、非驱动端端盖外盖	14、Out bearing cap N.D.E.
15、风扇	15、Fan
16、风罩	16、Fan cowl

基本结构说明 Specifications standard construction	
铸铁机座和接线盒	Cast iron frame,terminal box.
钢板冲压风罩	Pressed steel fan cowl.
铸铁端盖	Cast iron endshields.
聚丙烯玻璃纤维风扇	Polypropylene,glass reinforced fan.
电机专用轴承	Equivalent bearings.

特性 Features	
电机尺寸和额定功率符合IEC 60072	Dimensions and ratings to IEC 60072
GB/T4772.1~4772.3	GB/T4772.1~4772.3
IP55	IP55
接线盒在上面	Top mounted terminal box.
接线盒可90° 旋转	Terminal box rotates in 90 deg
冷却方式IC411	Cooling IC411

安装 Mounting	
B3-卧式底脚安装	B3-foot mounted
B35-底脚凸缘安装	B35-foot and flange mounted
V1-立式凸缘安装	V1-flange mounted-vertical

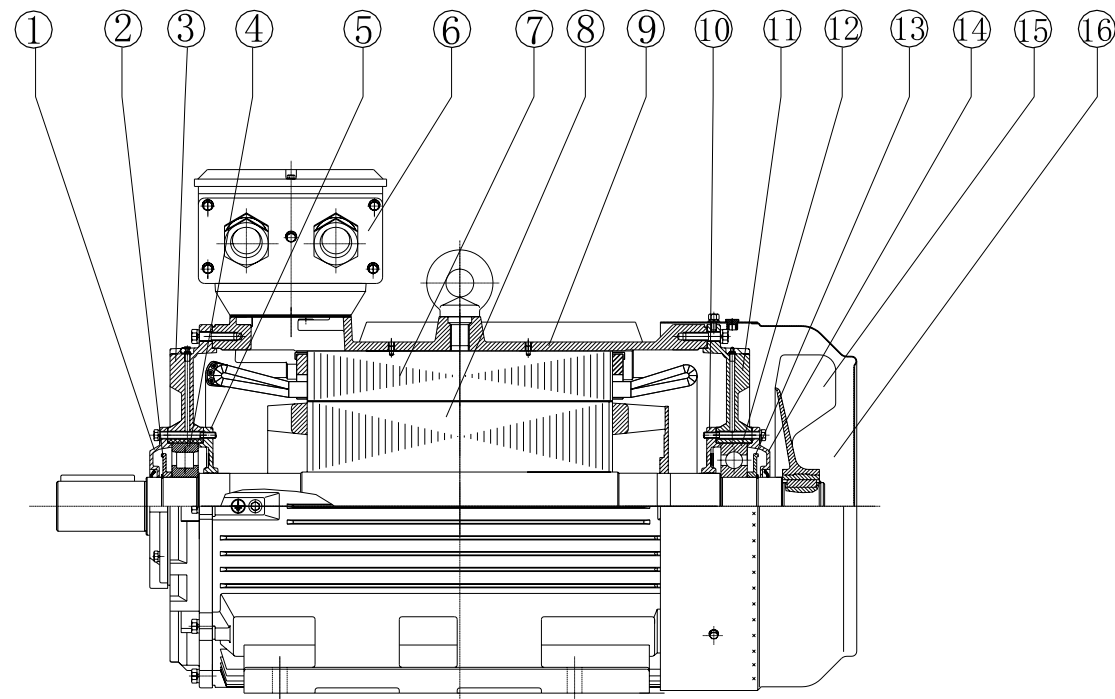

技术数据 Technical data

2极-同步转速3000r/min 50Hz
2 pole-3000 rpm synchronous speed 50Hz

型号 motor type	额定 功率 rated output KW	额定 转速 rated speed rpm	额定 电流 1FL 380V A	额定 电流 1FL 400V A	额定 电流 1FL 415V A	额定 电流 1FL 525V A	效率 EFF %	功率 因数 power factor cos φ	额定 转矩 rated torque N.m	起动 转矩 额定 转矩 TST/TFL	最大 转矩 额定 转矩 TM/TFL	起动 电流 额定 电流 IST/IFL	转动 惯量 M of 1 kgm ²	噪音 noise level LW dB(A)	重量 net weight kg
YE2-801-2	0.75	2855	1.8	1.7	1.6	1.3	77.4	0.83	2.5	2.4	2.5	6.5	0.001	62	18
YE2-802-2	1.1	2855	2.5	2.4	2.3	1.8	79.8	0.84	3.7	2.4	2.5	6.7	0.002	62	20
YE2-90S-2	1.5	2875	3.3	3.1	3.0	2.4	81.4	0.85	5.0	2.4	2.6	7.3	0.002	67	26
YE2-90L-2	2.2	2875	4.7	4.4	4.3	3.4	83.2	0.86	7.3	2.4	2.6	7.4	0.003	67	30
YE2-100L-2	3	2880	6.1	5.8	5.6	4.4	84.6	0.88	9.9	2.5	2.5	7.8	0.005	74	37
YE2-112M-2	4	2900	7.9	7.5	7.3	5.7	86.0	0.89	13.2	2.3	2.6	8.1	0.008	77	47
YE2-132S1-2	5.5	2900	10.8	10.2	9.9	7.8	87.2	0.89	18.1	2.3	2.5	7.9	0.014	79	65
YE2-132S2-2	7.5	2900	14.5	13.8	13.3	10.5	88.2	0.89	24.7	2.3	2.5	7.8	0.018	79	73
YE2-160M1-2	11	2940	21.0	19.9	19.2	15.2	89.6	0.89	35.7	2.3	2.5	7.5	0.051	81	122
YE2-160M2-2	15	2940	28.0	26.6	25.6	20.3	90.4	0.90	48.7	2.2	2.5	7.2	0.064	81	133
YE2-160L-2	18.5	2940	34.7	33.0	31.8	25.1	90.9	0.89	60.1	2.3	2.4	7.5	0.076	81	152
YE2-180M-2	22	2955	41.1	39.0	37.6	29.7	91.4	0.89	71.1	2.4	2.4	8.1	0.105	83	192
YE2-200L1-2	30	2965	55.5	52.8	50.9	40.2	92.2	0.89	96.6	2.2	2.5	7.5	0.179	84	252
YE2-200L2-2	37	2965	68.2	64.8	62.5	49.4	92.6	0.89	119.2	2.1	2.6	7.5	0.201	84	275
YE2-225M-2	45	2970	82.6	78.5	75.6	59.8	93.0	0.89	144.7	2.2	2.5	7.5	0.305	86	315
YE2-250M-2	55	2975	100.6	95.6	92.1	72.8	93.3	0.89	176.6	2.2	2.5	7.6	0.414	89	417
YE2-280S-2	75	2975	136.4	129.5	124.9	98.7	93.9	0.89	240.8	1.9	2.6	6.9	0.695	91	571
YE2-280M-2	90	2975	163.1	155.0	149.4	118.1	94.2	0.89	288.9	2.0	2.6	6.9	0.852	91	607
YE2-315S-2	110	2980	196.7	186.9	180.1	142.4	94.4	0.90	352.5	1.9	2.5	7.0	1.753	92	965
YE2-315M-2	132	2980	235.3	223.5	215.5	170.3	94.7	0.90	423.0	1.9	2.4	7.0	1.874	92	1067
YE2-315L1-2	160	2980	281.5	267.4	257.8	203.8	94.9	0.91	512.8	1.9	2.4	7.1	2.296	92	1151
YE2-315L-2	185	2980	325.5	309.2	298	235.6	94.8	0.91	592.9	1.8	2.2	7.1	2.3872	92	1205
YE2-315L2-2	200	2980	351.5	333.9	321.9	254.4	95.0	0.9	640.9	1.8	2.2	7.1	2.478	92	1253
YE2-355M1-2	220	2980	391.0	371.5	358.0	283.0	95.0	0.91	705.0	1.6	2.2	7.1	2.900	100	1540
YE2-355M2-2	250	2980	444.2	422.0	406.8	321.6	95.0	0.91	801.2	1.6	2.2	7.1	3.498	100	1638
YE2-355L1-2	280	2980	497.6	472.6	455.6	360.0	95.0	0.91	897.3	1.6	2.2	7.2	4.095	100	1752
YE2-355L2-2	315	2980	559.8	531.7	512.6	405.0	95.0	0.91	1009.5	1.6	2.2	7.2	4.436	100	1834
YE2-3551-2	355	2980	631.0	599.3	577.6	456.6	95.0	0.91	1137.6	1.6	2.2	7.2	4.959	104	1936
YE2-3552-2	375	2980	666.0	633.0	610.2	482.3	95.0	0.90	1201.7	1.6	2.2	7.2	5.176	104	2180

YE2 系列高效三相异步电动机
SERIES HIGH EFFICIENCY THREE-PHASE INDUCTION MOTOR

技术数据 Technical data

4极-同步转速1500r/min 50Hz
4 pole-1500 rpm synchronous speed 50Hz

型号 motor type	额定 功率 rated output KW	额定 转速 rated speed rpm	额定 电流 1FL 380V A	额定 电流 1FL 400V A	额定 电流 1FL 415V A	额定 电流 1FL 525V A	效率 EFF %	功率 因数 power factor cos φ	额定 转矩 rated torque N.m	起动 转矩 额定 转矩 TST/TFL	最大 转矩 额定 转矩 TM/TFL	起动 电流 额定 电流 IST/IFL	转动 惯量 M of 1 kgm ²	噪音 noise level LW dB(A)	重量 net weight kg
YE2-802-4	0.75	1400	1.9	1.8	1.7	1.3	79.6	0.77	5.1	2.4	2.5	6.2	0.003	56	20
YE2-90S-4	1.1	1425	2.6	2.5	2.4	1.9	81.5	0.78	7.4	2.4	2.5	6.4	0.004	59	26
YE2-90L-4	1.5	1425	3.5	3.3	3.2	2.5	82.8	0.79	10.1	2.3	2.4	6.5	0.006	59	29
YE2-100L1-4	2.2	1440	4.9	4.7	4.5	3.5	84.3	0.81	14.6	2.4	2.5	7.2	0.010	64	37
YE2-100L2-4	3	1440	6.5	6.2	6.0	4.7	85.5	0.82	19.9	2.4	2.5	7.1	0.013	64	40
YE2-112M-4	4	1450	8.7	8.2	7.9	6.3	86.7	0.81	26.3	2.3	2.5	7.3	0.019	65	52
YE2-132S-4	5.5	1455	11.6	11.0	10.6	8.4	87.7	0.82	36.1	2.0	2.4	7.3	0.036	71	70
YE2-132M-4	7.5	1455	15.5	14.7	14.2	11.2	88.7	0.83	49.2	2.0	2.5	7.1	0.047	71	84
YE2-160M-4	11	1465	22.4	21.3	20.5	16.2	89.9	0.83	71.7	2.2	2.4	7.4	0.103	73	135
YE2-160L-4	15	1465	29.9	28.4	27.4	21.6	90.8	0.84	97.8	2.2	2.6	7.5	0.131	73	156
YE2-180M-4	18.5	1470	35.8	34.0	32.8	25.9	91.3	0.86	120.2	2.1	2.6	7.6	0.183	76	196
YE2-180L-4	22	1475	42.4	40.3	38.8	30.7	91.7	0.86	142.4	2.1	2.6	7.7	0.219	76	215
YE2-200L-4	30	1475	58.0	55.1	53.1	42.0	92.4	0.85	194.2	2.1	2.5	6.9	0.297	76	275
YE2-225S-4	37	1480	70.5	67.0	64.6	51.0	92.7	0.86	238.8	2.1	2.4	6.8	0.578	78	328
YE2-225M-4	45	1480	85.4	81.1	78.2	61.8	93.1	0.86	290.4	2.2	2.5	7.2	0.659	78	355
YE2-250M-4	55	1480	103.9	98.7	95.2	75.2	93.5	0.86	354.9	2.2	2.5	7.0	0.818	79	453
YE2-280S-4	75	1485	139.3	132.4	127.6	100.9	94.0	0.87	482.3	2.3	2.6	6.7	1.571	80	596
YE2-280M-4	90	1485	164.8	156.5	150.9	119.3	94.3	0.88	578.8	2.2	2.6	6.9	1.964	80	693
YE2-315S-4	110	1485	198.7	188.8	182.0	143.8	94.5	0.89	707.4	2.1	2.6	6.9	3.247	88	1012
YE2-315M-4	132	1485	238.0	226.1	217.9	172.2	94.7	0.89	848.9	2.1	2.6	6.9	3.527	88	1147
YE2-315L1-4	160	1485	284.6	270.4	260.6	206.0	94.9	0.90	1029.0	2.1	2.5	6.9	4.087	88	1224
YE2-315L-4	185	1485	329	312.7	301.3	297	94.9	0.90	1189	2.1	2.2	6.9	4.927	88	1295
YE2-315L2-4	200	1485	355.0	337.3	258.1	257.0	95.1	0.90	1286.2	2.1	2.6	6.9	5.374	88	1331
YE2-355M1-4	220	1490	390.5	371.0	357.6	282.7	95.1	0.90	1410.1	2.0	2.2	6.9	7.636	95	1620
YE2-355M2-4	250	1490	448.7	426.3	411.0	324.8	95.1	0.89	1602.3	2.0	2.2	6.9	8.404	95	1650
YE2-355L1-4	280	1490	502.6	477.5	460.2	353.8	95.1	0.89	1794.6	2.0	2.2	6.9	9.164	95	1752
YE2-355L2-4	315	1490	565.5	537.2	517.8	409.2	95.1	0.89	2019.0	2.0	2.2	6.9	9.927	95	1804
YE2-3551-4	355	1490	637.3	605.4	583.5	461.3	95.1	0.89	2275.3	1.7	2.2	6.5	11.157	102	2083
YE2-3552-4	375	1490	673.0	639.5	616.4	487.2	95.1	0.89	2403.5	1.7	2.2	6.5	12.600	102	2160

技术数据 Technical data

6极-同步转速1000r/min 50Hz
6 pole-1000 rpm synchronous speed 50Hz

型号 motor type	额定 功率 rated output KW	额定 转速 rated speed rpm	额定 电流 1FL 380V A	额定 电流 1FL 400V A	额定 电流 1FL 415V A	额定 电流 1FL 525V A	效率 EFF %	功率 因数 power factor cos φ	额定 转矩 rated torque N.m	起动 转矩 额定 转矩 TST/TFL	最大 转矩 额定 转矩 TM/TFL	起动 电流 额定 电流 IST/IFL	转动 惯量 M of 1 kgm ²	噪音 noise level LW dB(A)	重量 net weight kg
YE2-90S-6	0.75	935	2.1	2.0	1.9	1.5	76.1	0.71	7.7	2.2	2.4	5.6	0.005	57	24
YE2-90L-6	1.1	940	2.9	2.8	2.7	2.1	78.2	0.73	11.2	2.2	2.5	5.5	0.008	57	28
YE2-100L-6	1.5	945	3.9	3.7	3.6	2.8	79.8	0.73	15.2	2.1	2.4	5.6	0.013	61	34
YE2-112M-6	2.2	950	5.6	5.3	5.1	4.0	82.0	0.73	22.1	2.1	2.3	6.0	0.020	65	45
YE2-132S-6	3	960	7.6	7.2	6.9	5.5	83.5	0.72	29.8	2.2	2.4	6.4	0.038	69	60
YE2-132M1-6	4	960	9.7	9.2	8.9	7.0	84.7	0.74	39.8	2.1	2.4	6.5	0.050	69	69
YE2-132M2-6	5.5	960	12.8	12.1	11.7	9.3	86.0	0.76	54.7	2.1	2.3	6.4	0.066	69	82
YE2-160M-6	7.5	970	16.7	15.9	15.3	12.1	87.5	0.78	73.8	2.3	2.5	6.8	0.121	73	116
YE2-160L-6	11	970	23.8	22.6	21.8	17.2	88.9	0.79	108.3	2.1	2.5	6.7	0.161	73	143
YE2-180L-6	15	975	30.6	29.0	28.0	22.1	89.8	0.83	146.9	2.2	2.4	7.3	0.264	73	181
YE2-200L1-6	18.5	975	38.3	36.4	35.1	27.7	90.6	0.81	181.2	2.1	2.5	7.0	0.407	73	230
YE2-200L2-6	22	975	44.7	42.5	41.0	32.4	91.1	0.82	215.5	2.1	2.4	7.0	0.459	73	239
YE2-225M-6	30	985	60.6	57.5	55.4	43.8	91.8	0.82	290.9	2.3	2.3	6.6	0.648	74	301
YE2-250M-6	37	985	73.3	69.6	67.1	53.1	92.4	0.83	358.7	2.3	2.6	7.0	0.979	76	387
YE2-280S-6	45	985	86.8	82.4	79.5	62.8	92.7	0.85	436.3	2.1	2.5	6.8	1.790	78	501
YE2-280M-6	55	985	104.4	99.2	95.6	75.5	93.1	0.86	533.2	2.2	2.5	7.1	2.164	78	547
YE2-315S-6	75	990	144.6	137.4	132.4	104.7	93.8	0.84	723.5	2.1	2.5	6.5	4.279	83	976
YE2-315M-6	90	990	171.0	162.4	156.5	123.7	94.1	0.85	868.2	2.0	2.5	6.4	5.017	83	1007
YE2-315L1-6	110	990	208.3	197.9	190.7	150.8	94.4	0.85	1061.1	2.1	2.5	6.5	5.607	83	1097
YE2-315L2-6	132	990	246.5	234.2	225.7	178.4	94.6	0.86	1273.3	2.1	2.5	6.6	6.640	83	1168
YE2-355M1-6	160	990	298.2	283.3	273.0	215.8	94.8	0.86	1543.4	2.0	2.0	6.7	9.555	85	1554
YE2-355M-6	185	990	344.8	327.5	315.7	249.6	94.8	0.86	1784.6	2.0	2.0	6.8	10.511	85	1691
YE2-355M2-6	200	990	367.6	349.3	336.7	266.0	95.0	0.87	1929.3	2.0	2.0	6.8	11.944	85	1768
YE2-355L1-6	220	990	409.1	388.7	374.6	296.1	95.0	0.86	2122.2	2.0	2.0	6.8	12.899	85	1838
YE2-355L2-6	250	990	464.9	441.7	425.7	336.5	95.0	0.86	2411.6	2.0	2.0	6.8	13.377	85	1902
YE2-3551-6	280	990	520.7	494.7	476.8	376.9	95.0	0.86	2701.0	2.0	2.0	6.8	13.855	91	2011
YE2-3552-6	315	990	585.8	556.5	536.4	424.0	95.0	0.86	3038.6	2.0	2.0	6.8	14.333	91	2090

YE2 系列高效三相异步电动机
SERIES HIGH EFFICIENCY THREE-PHASE INDUCTION MOTOR

B3外形及安装尺寸 Dimensions foot mount B3

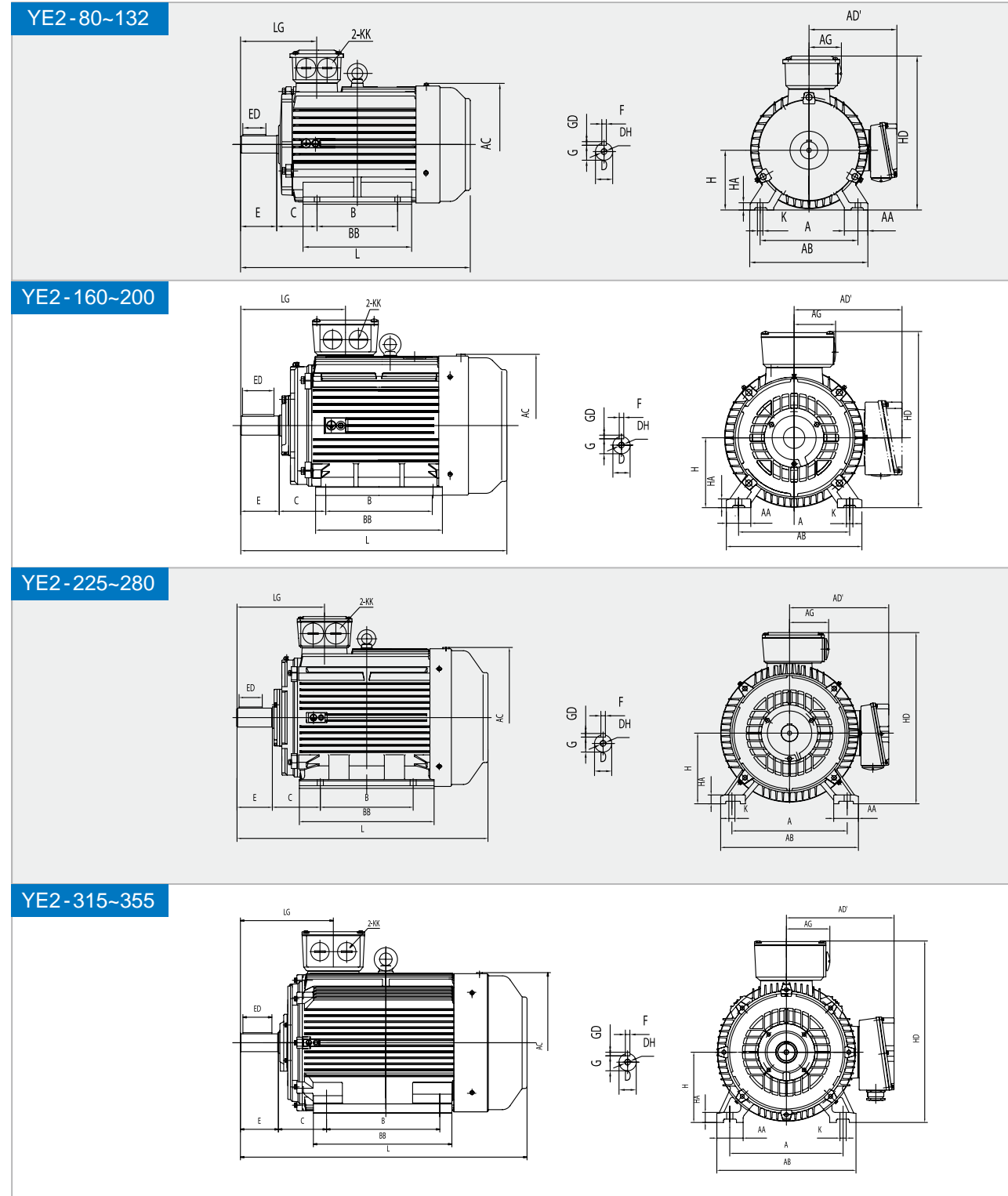

B3外形及安装尺寸 Dimensions foot mount B3

机座号	A	AA	AB	AC	AD'	B	BB	C	D	E	ED	F	G	GD	H	HA	HD	K	KK	L	LG
80	125	34	165	175	140	100	142	50	19	40	22	6	15.5	6	80	10	220	10	M24X1.5	301	112
90S	140	36	180	195	150	100	180	56	24	50	32	8	20	7	90	12.5	260	10	M24X1.5	360	126
90L	140	36	180	195	150	125	210	56	24	50	32	8	20	7	90	12.5	260	10	M24X1.5	390	126
100L	160	40	205	215	160	140	233	63	28	60	40	8	24	7	100	14	275	12	M24X1.5	435	153
112M	190	45	230	240	185	140	252	70	28	60	40	8	24	7	112	14	310	12	M30X2	480	144
132S	216	52	270	275	205	140	220	89	38	80	56	10	33	8	132	16	345	12	M30X2	510	167
132M	216	52	270	275	205	178	258	89	38	80	56	10	33	8	132	16	345	12	M30X2	550	167
160M	254	65	320	330	250	210	305	108	42	110	80	12	37	8	160	19	425	14.5	M36X2	667	270
160L	254	65	320	330	250	254	325	108	42	110	80	12	37	8	160	19	425	14.5	M36X2	689	270
180M	279	74	350	380	270	241	330	121	48	110	80	14	42.5	9	180	22	460	14.5	M36X2	732	277
180L	279	74	350	380	270	279	370	121	48	110	80	14	42.5	9	180	22	460	14.5	M36X2	780	277
200L	318	85	395	420	325	305	370	133	55	110	90	16	49	10	200	25	475	18.5	M48X2	779	298
225S(4-6P)	356	80	436	465	335	286	355	149	60	140	100	18	53	11	225	28	560	18.5	M48X2	836	340
225M(2P)	356	80	436	465	335	311	380	149	55	110	80	16	49	10	225	28	560	18.5	M48X2	831	310
225M(4-6P)	356	80	436	465	335	311	380	149	60	140	100	18	53	11	225	28	560	18.5	M48X2	866	340
250M(2P)	406	88	495	520	370	349	440	168	60	140	100	18	53	11	250	33	620	24	M64X2	936	360
250M(4-6P)	406	88	495	520	370	349	440	168	65	140	100	18	58	11	250	33	620	24	M64X2	942	360
280S(2P)	457	90	550	570	395	368	495	190	65	140	100	18	58	11	280	35	685	24	M64X2	970	350
280S(4-6P)	457	90	550	570	395	368	495	190	75	140	100	20	67.5	12	280	35	685	24	M64X2	975	350
280M(2P)	457	90	550	570	395	419	535	190	65	140	100	18	58	11	280	35	685	24	M64X2	1020	350
280M(4-6P)	457	90	550	570	395	419	535	190	75	140	100	20	67.5	12	280	35	685	24	M64X2	1015	350
315S(2P)	508	120	635	650	495	406	565	216	65	140	100	18	58	11	315	45	820	28	M64X2	1160	387
315M(2P)	508	120	635	650	495	457	675	216	65	140	100	18	58	11	315	45	820	28	M64X2	1270	387
315L(2P)	508	120	635	650	495	508	675	216	65	140	100	18	58	11	315	45	820	28	M64X2	1270	387
315S(4-6P)	508	120	635	650	495	406	515	216	80	170	130	22	71	14	315	45	820	28	M64X2	1207	417
315M(4-6P)	508	120	635	650	495	457	625	216	80	170	130	22	71	14	315	45	820	28	M64X2	1317	417
315L(4-6P)	508	120	635	650	495	508	625	216	80	170	130	22	71	14	315	45	820	28	M64X2	1317	417
355M(2P)	610	125	735	735	650	560	775	254	75	140	110	20	67.5	12	355	49	1000	28	M72X2	1500	420
355L(2P)	610	125	735	735	650	630	775	254	75	140	110	20	67.5	12	355	49	1000	28	M72X2	1500	420
355M(4-6P)	610	125	735	735	650	560	775	254	95	170	140	25	86	14	355	49	1000	28	M72X2	1530	450
355L(4-6P)	610	125	735	735	650	630	875	254	95	170	140	25	86	14	355	49	1000	28	M72X2	1630	450

YE2 系列高效三相异步电动机
SERIES HIGH EFFICIENCY THREE-PHASE INDUCTION MOTOR

B35外形及安装尺寸 Dimensions foot-flange mount B35

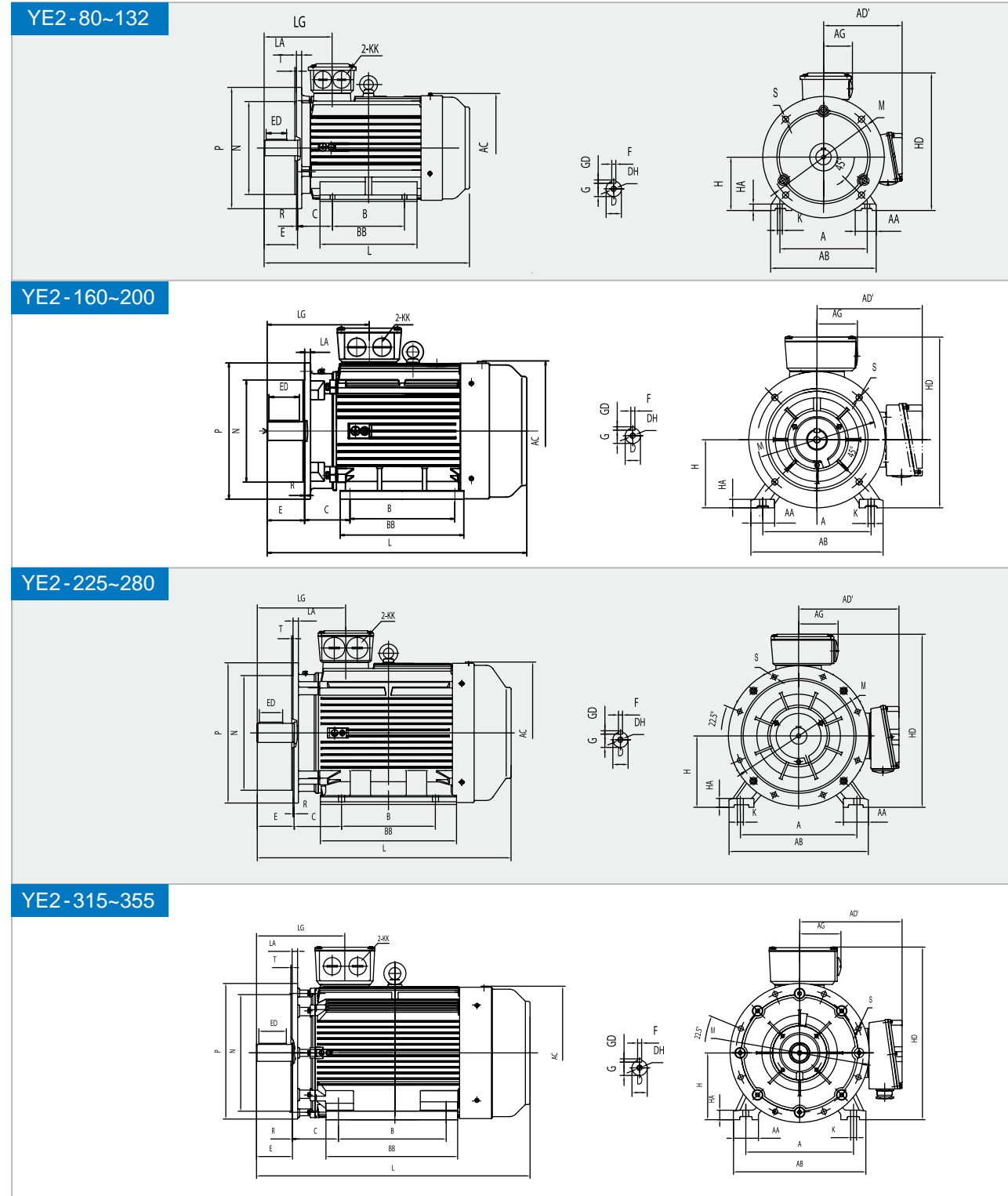

B35外形及安装尺寸 Dimensions foot-flange mount B35

机座号	A	AA	AB	AC	AD'	B	BB	C	D	E	ED	F	G	GD	H	HA	HD	K	L	LA	LG	M	N	P	S	T	KK
80	125	34	160	175	140	100	130	50	19	40	22	6	15.5	6	80	10	220	10	301	14	112	165	130	200	12	3.5	M24X1.5
90S	140	36	180	190	150	100	160	56	24	50	32	8	20	7	90	12.5	260	10	360	12	126	165	130	200	12	3.5	M24X1.5
90L	140	36	180	190	150	125	160	56	24	50	32	8	20	7	90	12.5	260	10	390	12	126	165	130	200	12	3.5	M24X1.5
100L	160	40	200	215	160	140	182	63	28	60	40	8	24	7	100	14	270	12	435	14	153	215	180	250	14.5	4	M24X1.5
112M	190	45	230	236	185	140	195	70	28	60	40	8	24	7	112	14	300	12	480	12	144	215	180	250	14.5	4	M30X2
132S	216	52	265	275	205	140	205	89	38	80	56	10	33	8	132	16	345	12	510	13	167	265	230	300	14.5	4	M30X2
132M	216	52	265	275	205	178	245	89	38	80	56	10	33	8	132	16	345	12	550	13	167	265	230	300	14.5	4	M30X2
160M	254	67	320	330	250	210	305	108	42	110	80	12	37	8	160	19	420	14.5	667	15	267.5	300	250	350	18.5	5	M36X2
160L	254	67	320	330	250	254	325	108	42	110	80	12	37	8	160	19	420	14.5	689	15	267.5	300	250	350	18.5	5	M36X2
180M	279	74	350	380	270	241	330	121	48	110	80	14	42.5	9	180	22	430	14.5	732	15	277	300	250	350	18.5	5	M36X2
180L	279	74	350	380	270	279	370	121	48	110	80	14	42.5	9	180	22	430	14.5	780	15	277	300	250	350	18.5	5	M36X2
200L	318	85	395	420	325	305	370	133	55	110	90	16	49	10	200	25	475	18.5	779	17	300	350	300	400	18.5	5	M48X2
225S(4-6P)	356	80	436	465	335	286	355	149	60	140	100	18	53	11	225	28	560	18.5	836	19	340	400	350	450	18.5	5	M48X2
225M(2P)	356	80	436	465	335	311	380	149	55	110	80	16	49	10	225	28	560	18.5	831	19	310	400	350	450	18.5	5	M48X2
225M(4-6P)	356	80	436	465	335	311	380	149	60	140	100	18	53	11	225	28	560	18.5	866	19	340	400	350	450	18.5	5	M48X2
250M(2P)	406	88	495	520	370	349	440	168	60	140	100	18	53	11	250	33	620	24	936	20	360	500	450	550	18.5	5	M64X2
250M(4-6P)	406	88	495	520	370	349	440	168	65	140	100	18	58	11	250	33	620	24	942	20	360	500	450	550	18.5	5	M64X2
280S(2P)	457	90	550	570	395	368	495	190	65	140	100	18	58	11	280	35	685	24	970	22	350	500	450	550	18.5	5	M64X2
280S(4-6P)	457	90	550	570	395	368	495	190	75	140	100	20	67.5	12	280	35	685	24	975	22	350	500	450	550	18.5	5	M64X2
280M(2P)	457	90	550	570	395	419	535	190	65	140	100	18	58	11	280	35	685	24	1020	22	350	500	450	550	18.5	5	M64X2
280M(4-6P)	457	90	550	570	395	419	535	190	75	140	100	20	67.5	12	280	35	685	24	1015	22	350	500	450	550	18.5	5	M64X2
315S(2P)	508	120	635	650	495	406	515	216	65	140	100	18	58	11	315	45	820	28	1160	24	387	600	550	660	24	6	M64X2
315M(2P)	508	120	635	650	495	457	625	216	65	140	100	18	58	11	315	45	820	28	1270	24	387	600	550	660	24	6	M64X2
315L(2P)	508	120	635	650	495	508	625	216	65	140	100	18	58	11	315	45	820	28	1270	24	387	600	550	660	24	6	M64X2
315S(4-6P)	508	120	635	650	495	406	515	216	80	170	130	22	71	14	315	45	820	28	1207	24	417	600	550	660	24	6	M64X2
315M(4-6P)	508	120	635	650	495	457	625	216	80	170	130	22	71	14	315	45	820	28	1317	24	417	600	550	660	24	6	M64X2
315L(4-6P)	508	120	635	650	495	508	625	216	80	170	130	22	71	14	315	45	820	28	1317	24	417	600	550	660	24	6	M64X2
355M(2P)	610	125	735	735	650	560	775	254	75	140	110	20	67.5	12	355	49	1000	28	1500	25	420	740	680	800	24	6	M72X2
355L(2P)	610	125	735	735	650	630	775	254	75	140	110	20	67.5	12	355	49	1000	28	1500	25	420	740	680	800	24	6	M72X2
355M(4-6P)	610	125	735	735	650	560	775	254	95	170	140	25	86	14	355	49	1000	28	1530	25	450	740	680	800	24	6	M72X2
355L(4-6P)	610	125	735	735	650	630	875	254	95	170	140	25	86	14	355	49	1000	28	1630	25	450	740	680	800	24	6	M72X2

注：图中R尺寸值均为0。The 'R' dimensions is zero.

YE2 系列高效三相异步电动机
SERIES HIGH EFFICIENCY THREE-PHASE INDUCTION MOTOR

B5、V1外形及安装尺寸 Dimensions flange mount B5 and V1

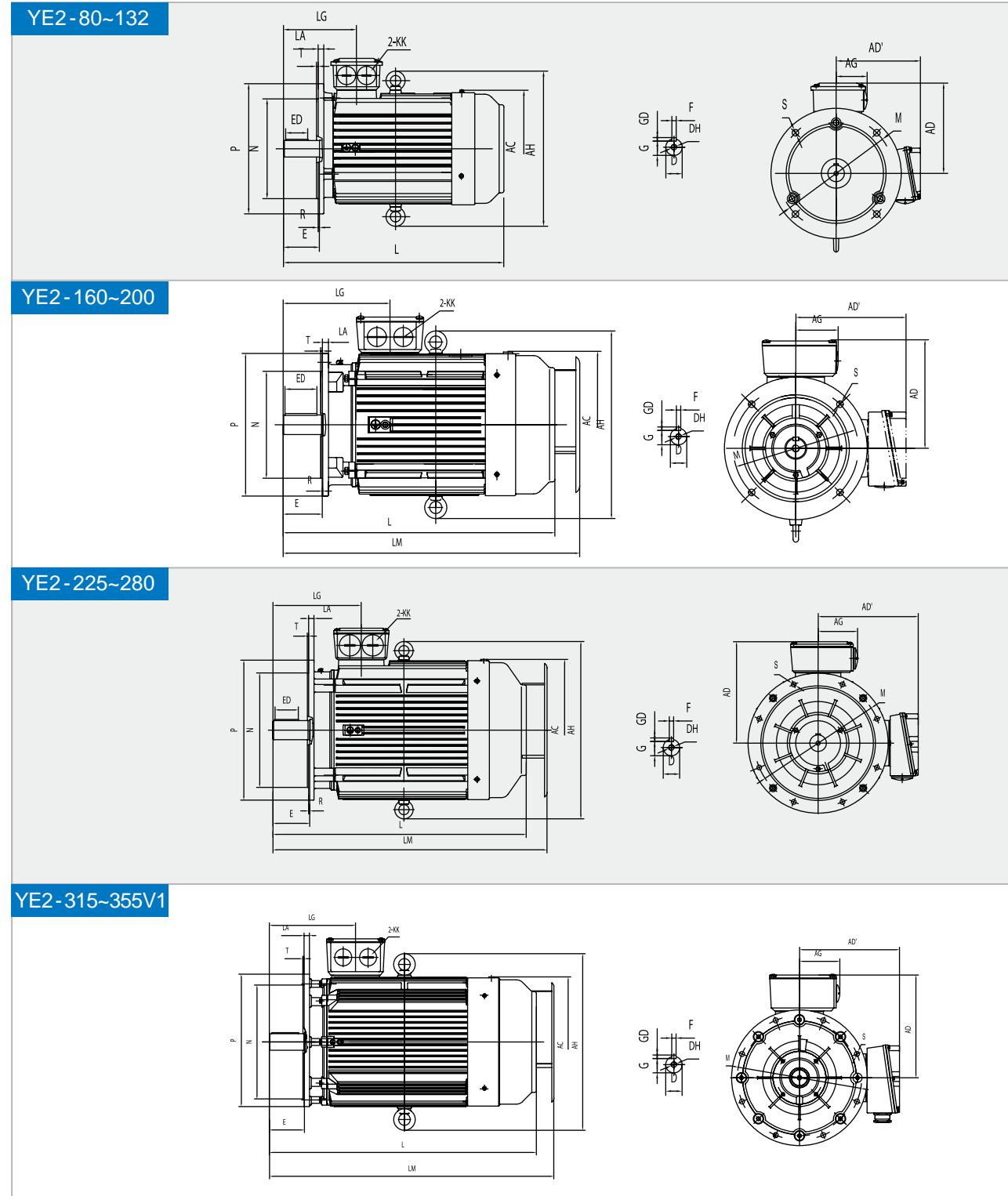

B5、V1外形及安装尺寸 Dimensions flange mount B5、V1

机座号	AC	D	AD	AD'	E	ED	F	G	GD	R	L	LA	LG	LM	M	N	P	S	T	KK
80	175	19	145	140	40	22	6	15.5	6	0	301	14	112	-	165	130	200	12	3.5	M24X1.5
90S	195	24	165	150	50	32	8	20	7	0	360	12	126	-	165	130	200	12	3.5	M24X1.5
90L	195	24	165	150	50	32	8	20	7	0	390	12	126	-	165	130	200	12	3.5	M24X1.5
100L	215	28	180	160	60	40	8	24	7	0	435	14	153	-	215	180	250	14.5	4	M24X1.5
112M	240	28	190	185	60	40	8	24	7	0	480	12	144	-	215	180	250	14.5	4	M30X2
132S	275	38	210	205	80	56	10	33	8	0	510	13	167	-	265	230	300	14.5	4	M30X2
132M	275	38	210	205	80	56	10	33	8	0	550	13	167	-	265	230	300	14.5	4	M30X2
160M	330	42	255	250	110	80	12	37	8	0	667	15	267.5	732	300	250	350	18.5	5	M36X2
160L	330	42	255	250	110	80	12	37	8	0	689	15	267.5	754	300	250	350	18.5	5	M36X2
180M	380	48	270	270	110	80	14	42.5	9	0	732	15	277	807	300	250	350	18.5	5	M36X2
180L	380	48	270	270	110	80	14	42.5	9	0	780	15	277	855	300	250	350	18.5	5	M36X2
200L	420	55	325	325	110	90	16	49	10	0	779	17	300	864	350	300	400	18.5	5	M48X2
225S(4-6P)	465	60	335	335	140	100	18	53	11	0	836	19	340	905	400	350	450	18.5	5	M48X2
225M(2P)	465	55	335	335	110	80	16	49	10	0	831	19	310	900	400	350	450	18.5	5	M48X2
225M(4-6P)	465	60	335	335	140	100	18	53	11	0	866	19	340	935	400	350	450	18.5	5	M48X2
250M(2P)	520	60	370	370	140	100	18	53	11	0	936	20	360	1062	500	450	550	18.5	5	M64X2
250M(4-6P)	520	65	370	370	140	100	18	58	11	0	942	20	360	1068	500	450	550	18.5	5	M64X2
280S(2P)	570	65	395	395	140	100	18	58	11	0	970	22	350	1100	500	450	550	18.5	5	M64X2
280S(4-6P)	570	75	395	395	140	100	20	67.5	12	0	975	22	350	1090	500	450	550	18.5	5	M64X2
280M(2P)	570	65	395	395	140	100	18	58	11	0	1020	22	350	1100	500	450	550	18.5	5	M64X2
280M(4-6P)	570	75	395	395	140	100	20	67.5	12	0	1015	22	350	1090	500	450	550	18.5	5	M64X2
315S(2P)	650	65	495	495	140	100	18	58	11	0	1160	24	387	1258	600	550	660	24	6	M64X2
315M(2P)	650	65	495	495	140	100	18	58	11	0	-	24	387	1368	600	550	660	24	6	M64X2
315L(2P)	650	65	495	495	140	100	18	58	11	0	-	24	387	1368	600	550	660	24	6	M64X2
315S(4-6P)	650	80	495	495	170	130	22	71	14	0	-	24	417	1288	600	550	660	24	6	M64X2
315M(4-6P)	650	80	495	495	170	130	22	71	14	0	-	24	417	1398	600	550	660	24	6	M64X2
315L(4-6P)	650	80	495	495	170	130	22	71	14	0	-	24	417	1398	600	550	660	24	6	M64X2
355M(2P)V1	735	75	645	650	140	110	20	67.5	12	0	-	25	420	1590	740	680	800	24	6	M72X2
355L(2P)V1	735	75	645	650	140	110	20	67.5	12	0	-	25	420	1590	740	680	800	24	6	M72X2
355M(4-6P)V1	735	95	645	650	170	140	25	86	14	0	-	25	450	1620	740	680	800	24	6	M72X2
355L(4-6P)V1	735	95	645	650	170	140	25	86	14	0	-	25	450	1720	740	680	800	24	6	M72X2

注：图中R尺寸值均为0。The 'R' dimensions is zero.

YE2 系列高效三相异步电动机
SERIES HIGH EFFICIENCY THREE-PHASE INDUCTION MOTOR

35512外形及安装尺寸 Mounting dimensions 35512

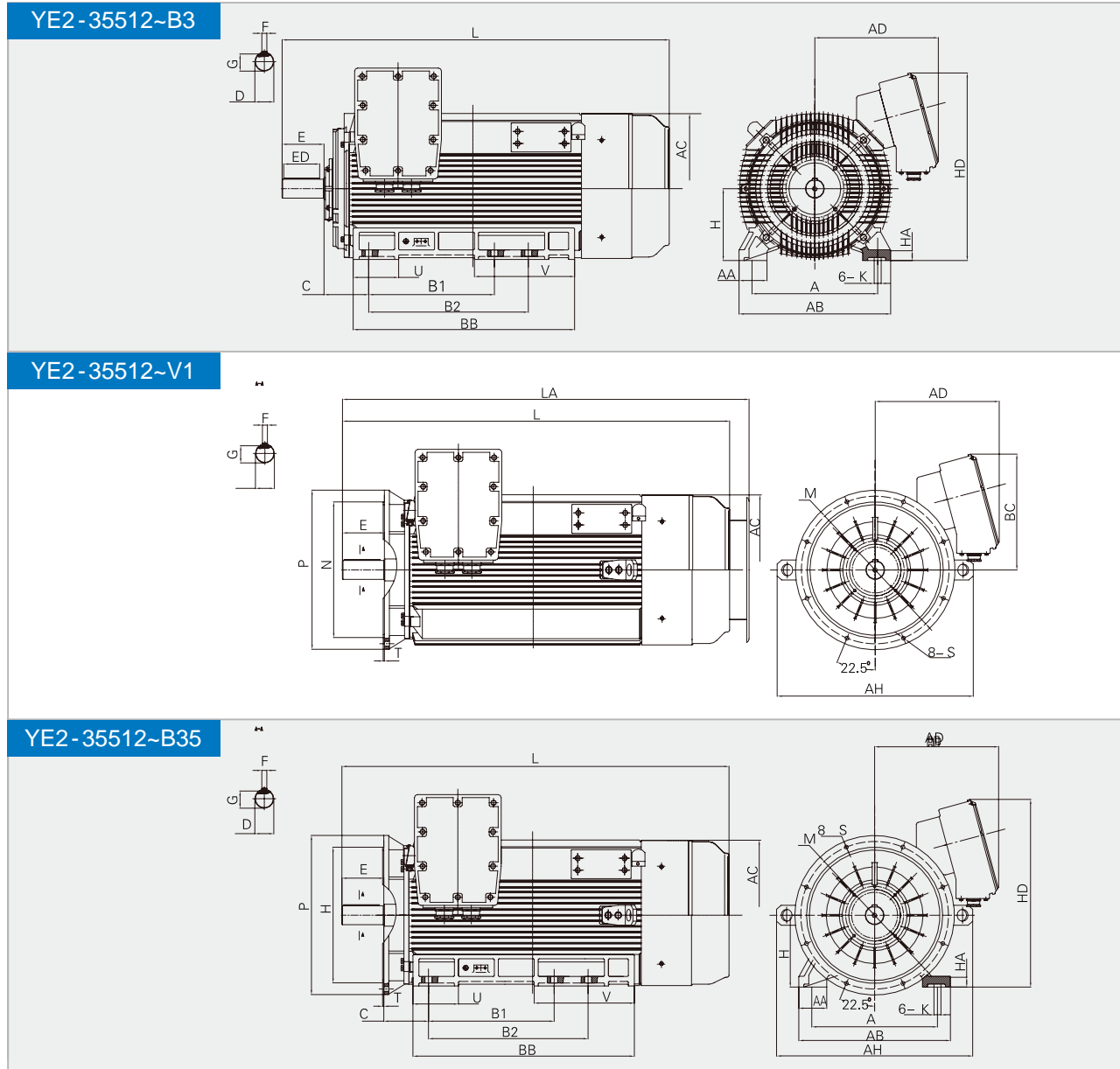

机座号 frame	A	AA	AB	AC	B1	B2	BB	C	D	E	ED	F	G	H	HA	AD	HD	K	U	V	M	N	P	S	T	L	LA	AH	BC
35512-2	630	140	760	760	630	800	1100	224	80	170	160	22	71	355	49	630	950	35	228	502	840	780	900	24	6	1850	1950	980	600
35512-4-6	630	140	760	760	630	800	1100	224	110	210	200	28	100	355	49	630	950	35	228	502	840	780	900	24	6	1940	2040	980	600

接线盒 Top terminal box

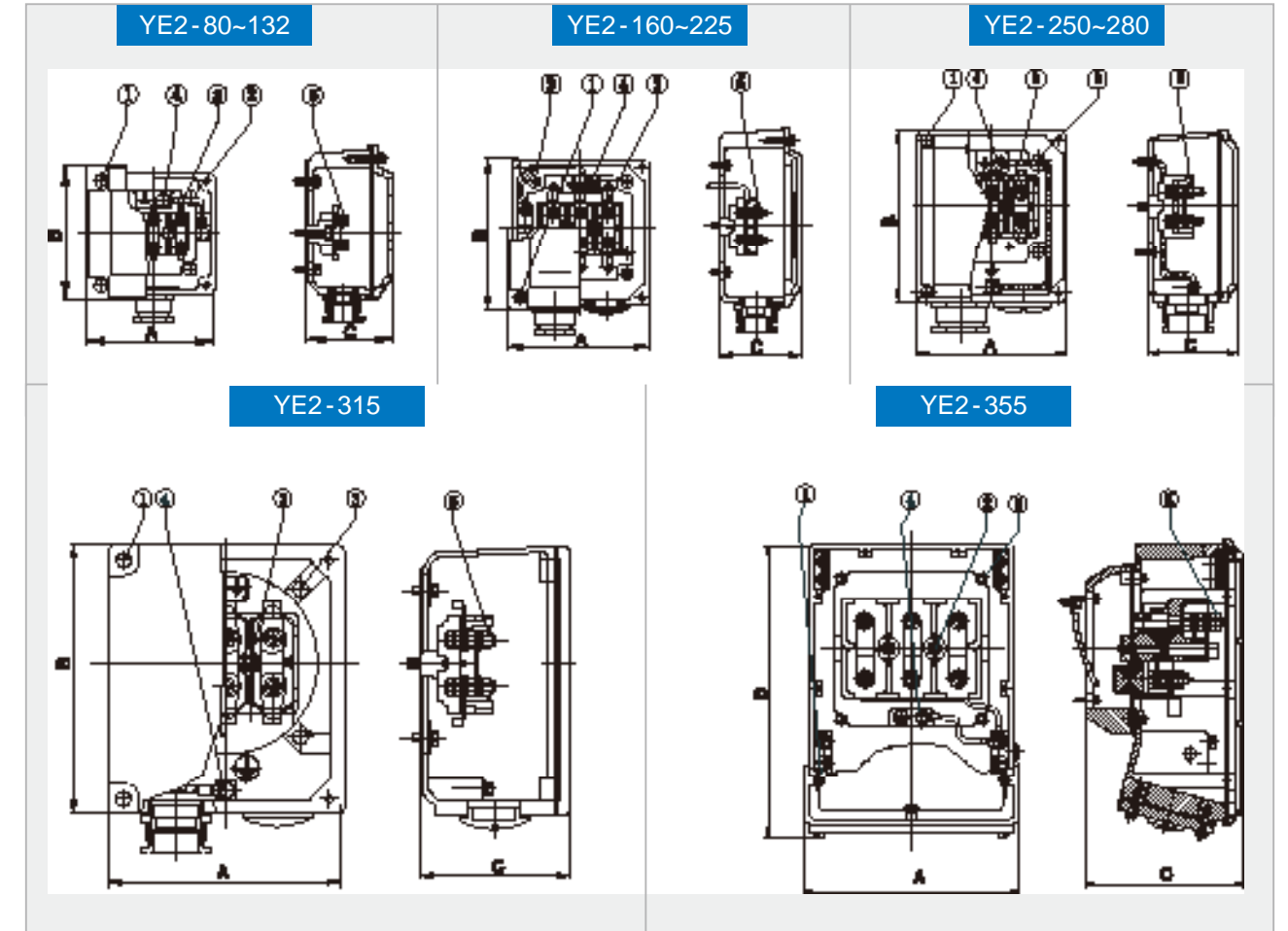

机座号 frame	A	B	C	1	2	3	4	5	螺纹尺寸 gland size	出线孔直径 outlet (dia.)
YE2-80	107	107	67	M5X16	M5X25	M5X16	M5X12	M4	M24X1.5	∅11
YE2-90-100	115	115	75	M5X16	M5X25	M5X16	M5X12	M4	M24X1.5	∅11
YE2-112-132	124	130	80	M5X16	M5X25	M5X20	M5X16	M5	2XM30X2	2 × ∅15
YE2-160-180	184	163	95	M5X16	M6X25	M6X16	M6X12	M6	2XM36X2	2 × ∅25
YE2-200-225	215	192	112	M5X25	M8X35	M8X25	M8X16	M8	2XM48X2	2 × ∅36
YE2-250-280	249	220	134	M5X25	M8X35	M8X25	M8X16	M10	2XM64X2	2 × ∅51
YE2-315	323	283	180	M5X25	M8X45	M10X25	M10X20	M12	2XM64X2	2 × ∅51
YE2-355	365	490	285	M12X30	M12X80	M12X30	M10X25	M20	2XM72X2	2 × ∅60

YE2 系列高效三相异步电动机
SERIES HIGH EFFICIENCY THREE-PHASE INDUCTION MOTOR

轴承和轴面油封 Bearing & lubrication

轴承数据
bearing data

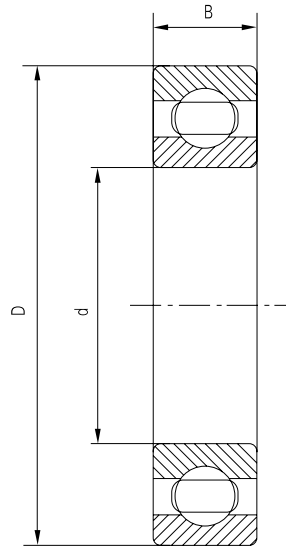

机座号 frame	轴伸端 DE	非轴伸端 NDE	d	D	B
YE2-80	6204ZZ	6204ZZ	20	47	14
YE2-90	6205ZZ	6205ZZ	25	52	15
YE2-100	6206ZZ	6206ZZ	30	62	16
YE2-110	6306ZZ	6306ZZ	30	72	19
YE2-132	6308ZZ	6308ZZ	40	90	23
YE2-160	6309	6309	45	100	25
YE2-180	6311	6311	55	120	29
YE2-200	6312	6312	60	130	31
YE2-225	6313	6313	65	140	33
YE2-250	6314	6314	70	150	35
YE2-250(V1)	6314	6314	70	150	35
YE2-280 2P	6314	6314	70	150	35
YE2-280 2P(V1)	6314	6314	70	150	35
YE2-280 4-6P	6317	6317	85	180	41
YE2-280 4-6P(V1)	6317	7317	85	180	41
YE2-315 2P	6316	6316	80	170	39
YE2-315 2P(V1)	6316	7316	80	170	39
YE2-315 4-6P	6319	6319	95	200	45
YE2-315 4-6P(V1)	6319	7319	95	200	45
YE2-355(2P) (B3,B35)	6319	6319	95	200	45
YE2-355(2P)V1	6319	7319	95	200	45
YE2-355(4-6P) (B3,B35)	6322	6322	110	240	50
YE2-355(4-6P)V1	6322	7322	110	240	50
YE2-35512(2P) (B3,B35)	319/C3	319/C3	95	200	45
YE2-35512(4-6P) (B3,B35)	Nu324	6324	120	260	55
YE2-35512(2P) V1	319C3	7319	95	200	45
YE2-35512(4-6P) V1	Nu324	7324	110	260	55

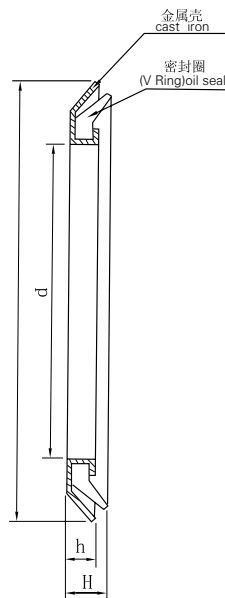

电机型号 motor type	油封规格 oil seal size	d	D	h	H
YE2-80	RB20×35×4.0	∅20	∅35	3.0	6.0
YE2-90	RB25×40×4.0	∅25	∅40	3.0	6.0
YE2-100	RB30×47×4.5	∅30	∅47	3.5	6.5
YE2-112	RB30×47×4.5	∅30	∅47	3.5	6.5
YE2-132	RB40×57×4.5	∅40	∅57	3.5	6.5
YE2-160	RB45×62×4.5	∅45	∅62	3.5	6.5
YE2-180	RB55×75×5.5	∅55	∅75	4.5	6.5
YE2-200	RB60×80×5.5	∅60	∅80	4.5	6.5
YE2-225	RB65×85×5.5	∅65	∅85	4.5	8.0
YE2-250	RB70×90×5.5	∅70	∅90	4.5	8.0
YE2-280-2	RB70×90×5.5	∅70	∅90	4.5	8.0
YE2-280-4.6	RB85×105×5.5	∅85	∅105	4.5	8.0
YE2-315-2	RB80×100×5.5	∅80	∅100	4.5	8.0
YE2-315-4.6	RB95×115×5.5	∅95	∅115	4.5	8.0
YE2-355-2	B95×120×12	∅95	∅120	-	12
YE2-355-4.6	B110×140×12	∅110	∅140	-	12
YE2-35512(2P)	B95×120×12	∅95	∅120	-	12
YE2-35512(4-6P)	B120×150×12	∅120	∅150	-	12

GUANGZHOU HAOQING MOTOR CO.,LTD

E-mail: sherry@gzhqmotor.com
Website: http://www.gzhqmotor.com